



ZOMEE

Zomee Fit Wearable Breast Pump



Worn inside your bra. Silent. Hands-Free. Comfortable.

Table of Contents

1	Product description	14	Hands-free capabilities
3	Expected use	22	Technical specifications
4	Safety	23	Problem solving
6	Starting		

1. PRODUCT DESCRIPTION

1.1 PARTS

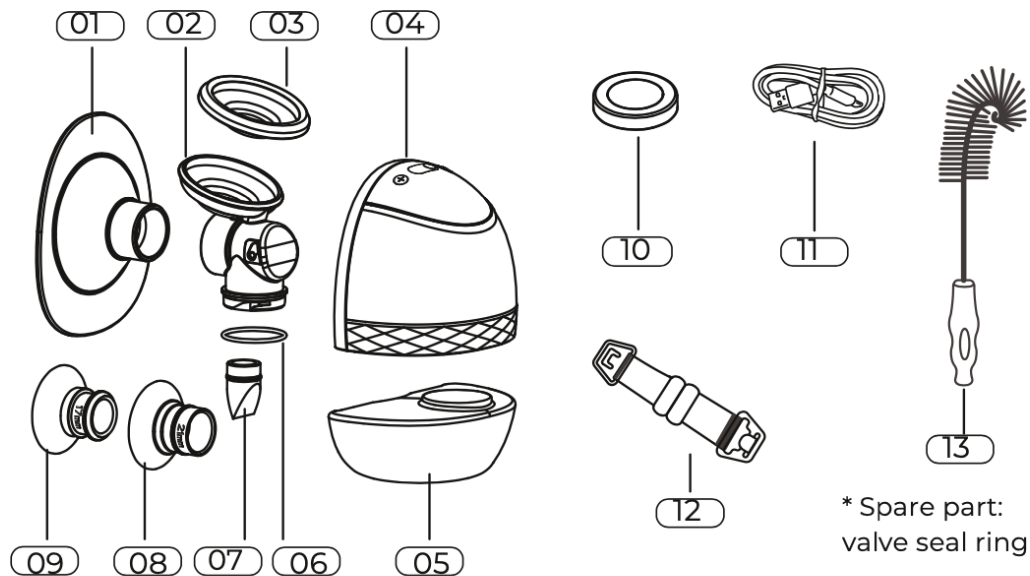

01 Breast Shield (25mm)

02 Breast Shield Body

03 Diaphragm

04 Pump Motor

05 150ml Collection Container

06 Seal Ring

07 Duckbill Valve

08 21mm Breast Shield Insert

09 17mm Breast Shield Insert

10 Collection Container Lid

11 Type-C Charging Cable

12 Bra Adjuster

13 Collection Container Brush

1. PRODUCT DESCRIPTION

1.2 CONTROLS

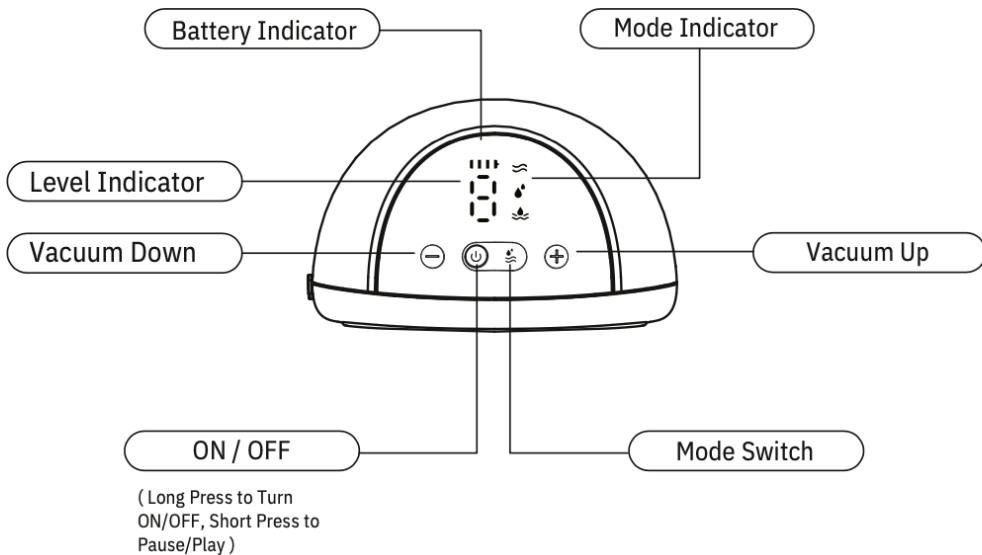

NOTE:

- This product has a built-in lithium battery. When the Battery Indicator light flashes while in use, we recommend that you use a certified 5V 2A Power Adapter to charge the device as soon as possible.

2. INTENDED USE

2.1 INDICATIONS FOR USE

Battery powered breast pump designed to express and collect breast milk from lactating moms, to alleviate engorgement of the breast(s), maintain the ability of lactation, and provide the mother's breast milk for future feedings when separation of mother and baby occurs. This device is intended for a single user.

3

2.2 REPLACEMENT PARTS

- The expected operating life of the replaceable washable components is between 3 to 6 months. This approximation is due to how frequently the parts are used and washing methods.
- It is recommended to replace the washable components after long-term storage or before using for a subsequent child.

NOTE:

- Zomee Fit has a 2-year warranty on the motor and a 90-day warranty on the pump parts. Please register your Zomee fit at support.zomee.com/warranty-registration.

3. SAFETY

3.1 WARNINGS

- This breast pump is intended as a single user product. Any use by more than one person may present a health risk to both mom and baby and voids the warranty.
- It is recommended that you consult with a licensed healthcare professional before using this wearable breast pump if you have an active implanted device that would be affected by a magnetic field (e.g. pacemaker, implantable cardioverter defibrillator).
- Prior to the first use, inspect for damage to any of the washable components and then clean and sterilize the components that may come into contact with your breast or breast milk.
- After every use, inspect for damage to any of the washable components and then clean the components that may come into contact with your breast or breast milk.
- During normal use, the wearable breast pump may warm up. If your pumping environment is at the upper operating suggested temperature limit (+30C/+86F) for the maximum session time of 30 minutes, the temperature of the cushion may reach up to +45C/+113F).
- Do not store parts that are wet or damp, as harmful bacteria, germs, or mold may develop.
- Do not immerse the pump motor in water or other liquids. Wipe with a clean, damp cloth. -
- Do not place the pump motor in the fridge or freezer.
- This product contains small parts that may present a hazard. Keep out of reach of children.
- Only use the manufactured parts with the Zomee Fit, including the charger. Do not substitute as that may compromise the performance of the pump or cause damage that is not covered under warranty.
- It's recommended to use an adaptor compatible with both IEC60601-1 and your regional power source.

3. SAFETY

3.2 PRECAUTIONS

5

- Always inspect all parts before use for damage or cleanliness.
- Always ensure all parts are completely dry before assembling.
- The Zomee Fit wearable breast pump and its components are not heat resistant. Keep away from heat sources.
- Do not use flammable materials while using this wearable pump or connecting this wearable pump to a charger.
- Do not use the Zomee Fit wearable breast pump while sleeping or overly drowsy.
Using an electric breast pump should not cause pain. Do not try to express with a setting that is too high or uncomfortable. If excessive discomfort or pain is felt during pumping, stop immediately by breaking the breast shield seal around your nipple and discontinue the session. Contact your healthcare professional if you express minimal or no breast milk, or if expression is painful.
For assistance with correct breast shield sizing and comfort, please see section 4.3 of this guide or talk to a lactation consultant or breastfeeding specialist.
- Extra care is necessary when using the Zomee Fit wearable breast pump in the vicinity of children.
The Zomee Fit wearable breast pump should not be used while lying down, or engaging in strenuous exercise or activities with risk of harm.
- Always break the seal around your nipple before removing this wearable pump from your breast.
Do not expose the Zomee Fit wearable breast pump or components to direct sunlight.
-

4.GETTING STARTED

4.1 CLEANING AND STERILIZING

- Before the first use and continuing after each use, you must disassemble, wash, and sterilize all the breast pump parts that come into contact with your breast and/or breast milk.
- Disassemble and clean all the breast pump parts that come into contact with your breast and/or breast milk immediately after each use, to avoid residual breast milk that may cause bacteria to grow.
- Take care when cleaning the silicone cushion, diaphragm, and valve. If these parts become damaged, your breast pump will not function properly.
- Never wash or sterilize the pump motor, as this component does not come into contact with your breast and/or breast milk. You can wipe this part clean with a soft cloth.



Do not get wet!



- Please be advised that the pump motor contains electronics that should always be kept dry. A clean, damp soft cloth can be used to wipe down the pump motor, if necessary. Any other cleaning method will be classed as misuse under the warranty.

4.GETTING STARTED

4.2 WASHABLE COMPONENTS

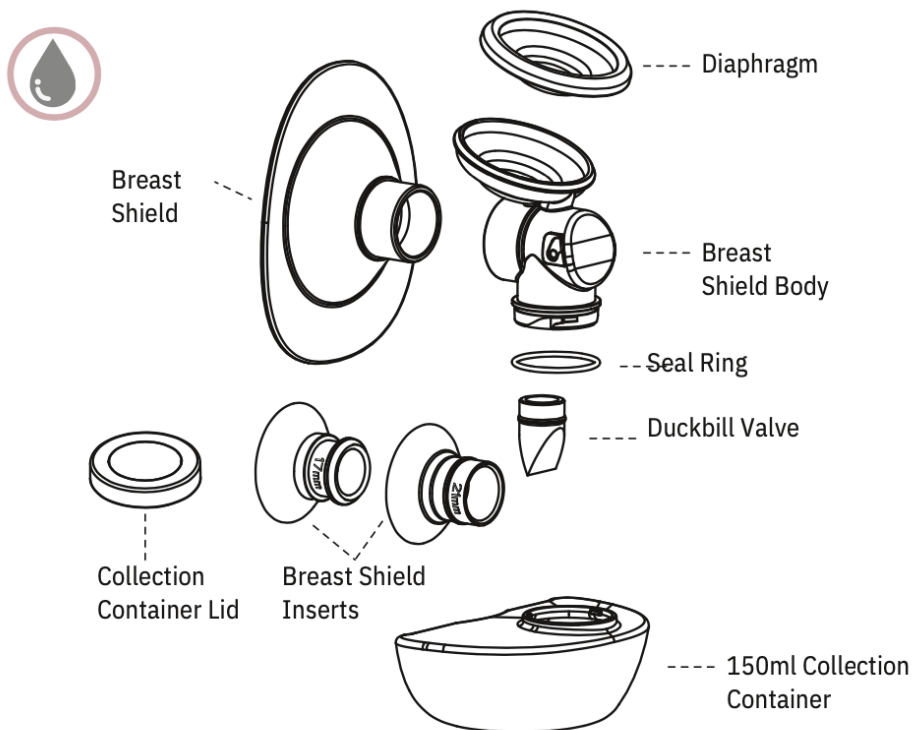

- Properly cleaning the washable component of your breast pump that come into contact with breast milk helps prevent the build-up of dry milk residue, which can cause the growth of bacteria that may be harmful to you and your baby.

WARNINGS:

- Missing the Seal Ring from assembly will cause a loss of vacuum.
- Please take care of the Seal Ring during washing/sterilizing, as this part is fragile.

4.GETTING STARTED

Cleaning washable components

1. Rinse in cold, clear water that is approx. +20C/+68F.
2. Wash with warm water (approx. +30C/+86F) using soap, and then wiping afterwards with a clean cloth.

3. Rinse in cold, clear water (approx. +20C/+68F) for 10 to 15 seconds.

OR

Place on the top shelf of the dishwasher (this method is not recommended as it can wear parts down faster).

+

Sterilizing Washable Components

Place in boiled water for no more than 5 minutes.

OR

Use a steam sterilizer, per manufacturer instructions. We do not recommend sterilizing pump parts using a steam sterilizer or microwave, as these methods can wear parts down faster.

4.GETTING STARTED

4.3 CHARGING

9

- 1.When the battery is low, the battery indicator light will flash.
- 2.The Zomee Fit breast pump will not power on for use, when charging. During charging, the battery indicator light will illuminate although the pump will not turn on.
3. Use the charging cable provided to connect the pump motor to a USB power source (5V 2A), such as your phone plug/AC adapter.
- 4.Use the charging cable provided to connect the pump motor to a USB power source (5V 2A), such as your phone plug/AC adapter.

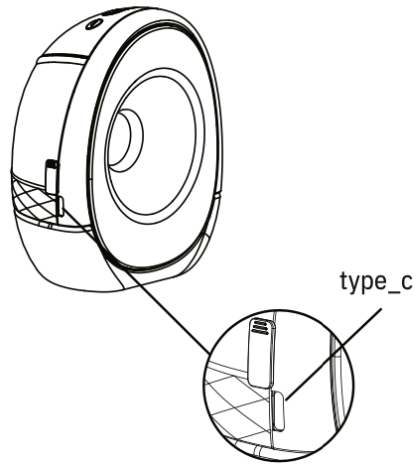

- Please only use the approved charging cable provided with the Zomee Fit. Do not use the pump while charging.

TIP:

- Charge immediately after finishing your pumping session if a lower battery is indicated.
- When the pump is working correctly, the screen display will automatically turn off if there is no further operation within 10 seconds, while the pump continues working.
- To illuminate the pump screen display, press any button on the control panel.

4.GETTING STARTED

4.4 BREAST SHIELD SIZING

The Zomee Fit wearable breast pump comes pre-assembled with a 25mm silicone breast shield. Included with your pump are two additional silicone inserts in sizes 17mm and 21mm.

Standard Shield

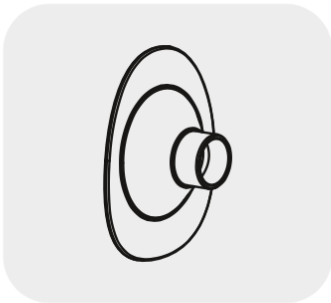

25mm

Additional Shield Inserts

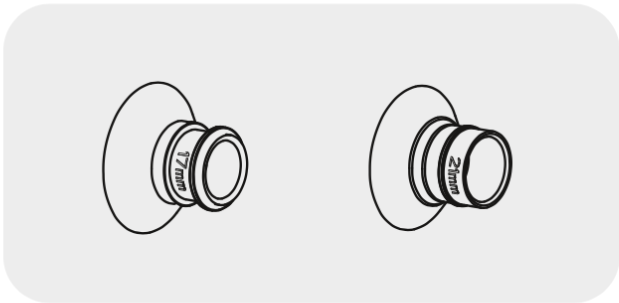

17mm

21mm

4.GETTING STARTED

4.5 ASSEMBLING THE PUMP

1. Ensure all pump parts that have been washed are completely dry before assembling them together.
2. Place the Diaphragm (03) in the Breast Shield Body (02).
3. Attach the Seal Ring (06) to the Breast Shield Body (02), making sure not to twist the Seal Ring.
4. Insert the Duckbill Valve (07) into the Breast Shield Body (02).

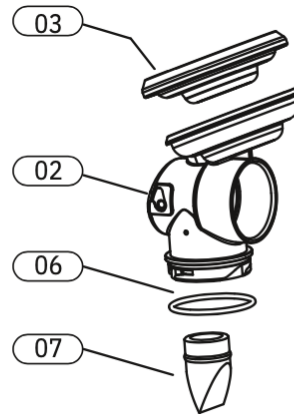

5. Push the assembled Breast Shield Body (A) into the Pump Motor (04), making sure it is aligned correctly and pieces (A) and (04) are secured.

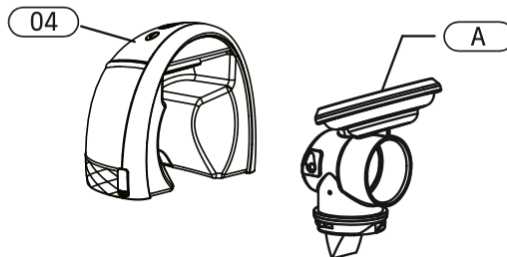

4.GETTING STARTED

4.6 ASSEMBLING THE PUMP (continued)

6. Twist the Collection Container (05) into the Pump Motor (01). Pay close attention to the screw-in position and direction.

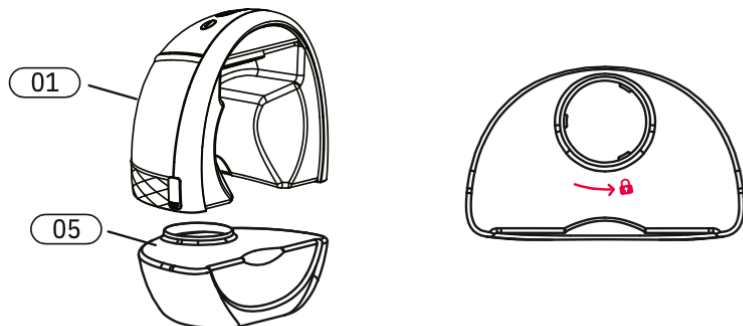

7. Push the Breast Shield (06) into the assembled Breast Shield Body (A), making sure parts are aligned correctly.

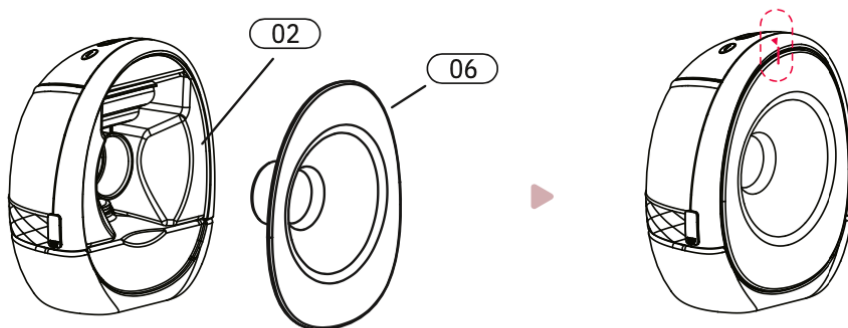

4.GETTING STARTED

4.6 ASSEMBLING THE PUMP (continued)

8. If the standard size 25mm Breast Shield (06) does not fit you appropriately, choose either the 17mm (09) or 21mm (08) silicone insert, and place directly into the center of the Breast Shield (06) tunnel.

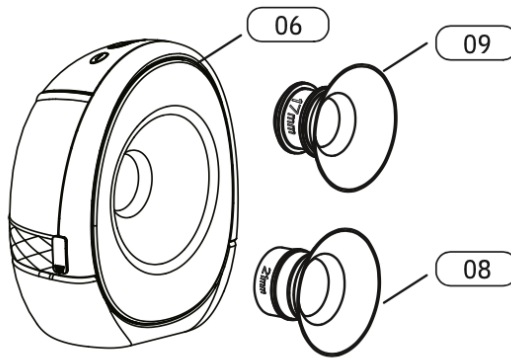

5. USING WEARABLE PUMP

5.1 SIZING SELECTION GUIDE

Since your breast shield size is also dependent on breast tissue and skin elasticity, it is important to confirm you've chosen the correct size. Here is how to check:

Using the breast shield size you have chosen, center your nipple and gently hold the breast shield against your breast.

Note: Pressing the breast shield too hard against your breasts when pumping can block your milk ducts.

NIPPLE DIAMETER (MM)	BREAST SHIELD SIZE
11MM-13MM	15MM
13MM-15MM	17MM
15MM-17MM	19MM
17MM-20MM	21MM
20MM-23MM	25MM

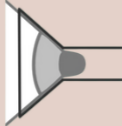

Perfect Fit

- During pumping your nipple can move freely in the breast shield tunnel
- You have space around your nipple and not much of the areola is drawn into the tunnel with the nipple

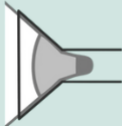

Too Big

- During pumping your areola is drawn into the breast shield tunnel
- You may experience your areola rubbing up against the side of the breast shield tunnel

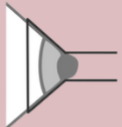

Too Small

- During pumping your entire nipple rubs against the sides of the breast shield tunnel

5. USING WEARABLE PUMP

5.3 FINDING THE RIGHT COMPRESSION

1. This wearable pump is designed to be worn with your standard nursing bra and can be used in either a sitting or standing position.
2. Every bra has a different level of support, therefore make sure to get the compression right before each session. If you are using a more structured bra, try using the Bra Adjuster (included with your pump) to create more room.
3. Once both ends of the adjuster are secured to your bra strap, adjust the length of the Bra adjuster until it is comfortable.

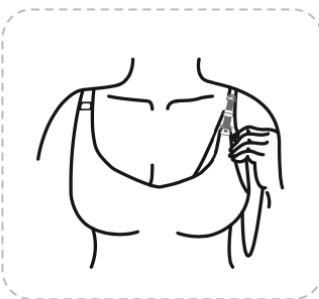
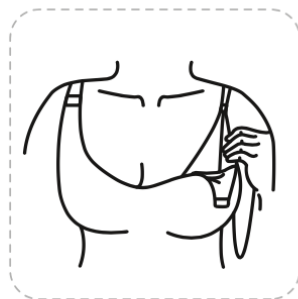

5. USING WEARABLE PUMP

5.4 POSTURES TO EXPRESS

17

IDEAL



Upright

✓ GOOD



slightly forward

✓ OK



bending forward

✗ CAN LEAK



reclining backrest

✗ IT DOES NOT WORK



Lying down (or on your side)

5. USING WEARABLE PUMP

5.5 STARTING YOUR SESSION

The Zomee Fit is intuitively designed for easy operation.

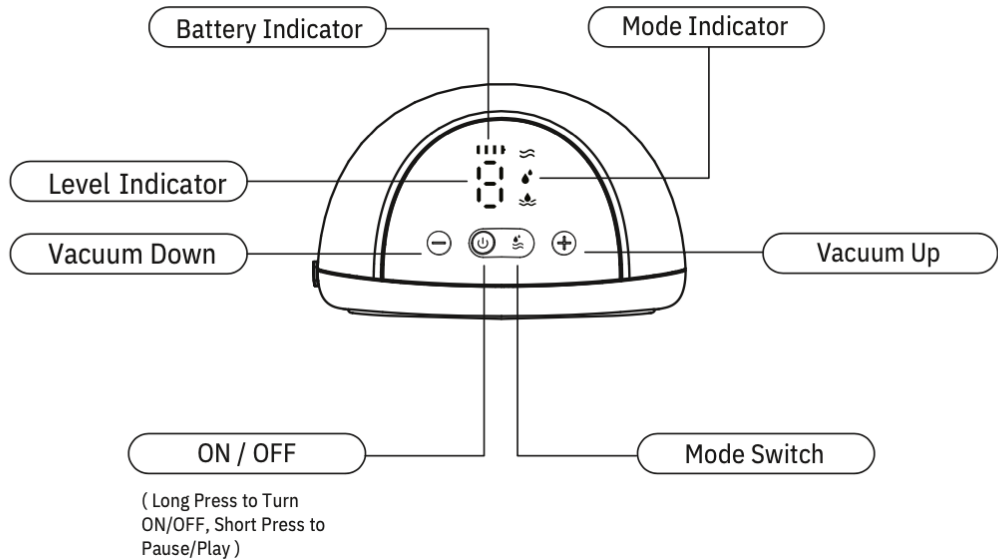

1 ON/OFF

- Firmly press On/Off button (or use a 'long press') to power the pump on, and the LED screen light will illuminate as it enters into standby mode.
- During working status, lightly press On/Off button (or use a 'short press') to Play/Pause if you need to pause pumping for any reason. -When the pause time exceeds 5 minutes, the pump will automatically shut off.

5. USING WEARABLE PUMP

5.6 STARTING YOUR SESSION

2 MODE

- Lightly pressing the On/Off button (or use a 'short press') when operating on standby status, the pump will automatically enter Stimulation Mode at the specific level from your last pumping session. For the first use of the pump, the default setting is to start from Stimulation Mode at Level 1.
- The pump will automatically switch to Expression Mode after 2 minutes of pumping. You can also manually press the Mode button to enter Expression Mode, or 2 Phase Mode if your milk starts to flow earlier.

3 VACCUUM SETTINGS

- There are 9 vacuum settings, giving the user control over what feels comfortable and what works most efficiently, using either Stimulation, Expression, or 2 Phase Mode.
- Once you can feel the suction on your nipple, use "+" or "." to adjust vacuum to find your preferred setting in all modes.

4 ENDING YOUR SESSION

- Firmly press the On/Off button (or use a 'long press') to stop pumping and power off the pump motor. Remember the pump will automatically shut off after 30 minutes of use as a safety precaution.
- Unclip your bra and use your finger to break the seal around your nipple, to avoid nipple damage.
- Remove the Zomee Fit wearable pump from your bra.

5. USING WEARABLE PUMP

5.7 STORING YOUR MILK

After finishing your pumping session, carefully twist the collection container (06) to remove it from the Pump Motor (01).

You may store your expressed breast milk in the collection container (06) using the Lid (10) or pour your expressed breast milk into a container of your choice from storage or feeding.

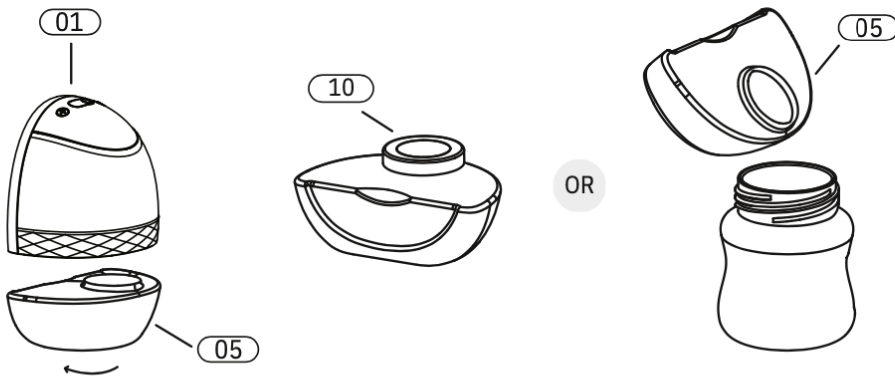

When storing milk, always follow the guidance of your lactation consultant or health professional.

WARNINGS:

- Clean all parts after every use that come into contact with your breast and/or breast milk and inspect for cleanliness and damage.
- Do not store wet or damp components, as harmful bacteria and mold may develop.

6. HOW TO DISSEMBLE?

21

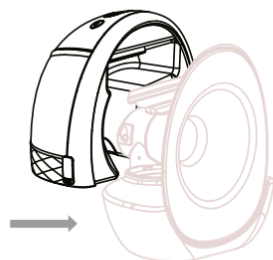
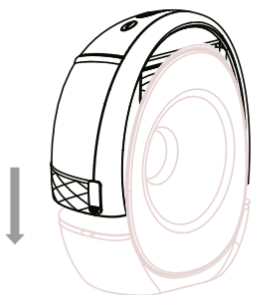
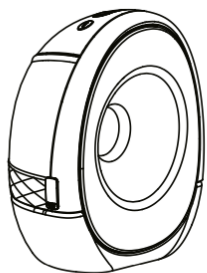

Step 1 : pull down

Step 2 : move forward

6. TECHNICAL SPECIFICATIONS

Power	5V 2A
Battery type and capacity	Li-ion Polymer Battery Specification: 3.7V 1300mAh
Stimulation speed	100 CPM (Cycle Per Minute)
Expression speed	26~60CPM (Cycle Per Minute)
Stimulation vacuum	30 - 120 mmhg , 9 levels adjustable
Expression vacuum	120 - 250 mmhg, 9 levels adjustable
Timer	30minutes
Noise	≤ 48dB(A)
Operation conditions	temperature 5°C ~40°C,humidity 10%~90%RH

7. TROUBLE SHOOTING

23

— Problem 1: Weak Suction or No Suction.

CAUSE	SOLUTION
Parts are assembled incorrectly.	Check whether the diaphragm is installed reversely or damaged. Reinstall or replace the diaphragm.
There is not a secure connection between the diaphragm and the pump motor.	Check whether there is a proper connection between the parts and tighten.
There is not a proper seal between the breast shield against the breast.	Check whether the breast shield is on the breast completely. Always keep the breast shield against the breast with the nipple centered properly in the breast shield tunnel.

— Problem 2: Pump Will Not Turn On or Charge.

CAUSE	SOLUTION
The provided charger is not being used.	Check whether the output of the charger meets the requirements and whether the charger is plugged in correctly.
The lithium battery has been exhausted.	Charge the pump once a low battery is indicated.

— Problem 3: Milk Back Flow.

CAUSE	SOLUTION
The Diaphragm is not installed properly or is damaged.	Immediately stop pumping and power off the pump. Clean all the washable components separately and wipe down the pump motor with a clean cloth. Please do not use again until the diaphragm is installed correctly or is replaced by a new one.

5. USING WEARABLE PUMP

5.2 ALIGNING YOUR NIPPLE

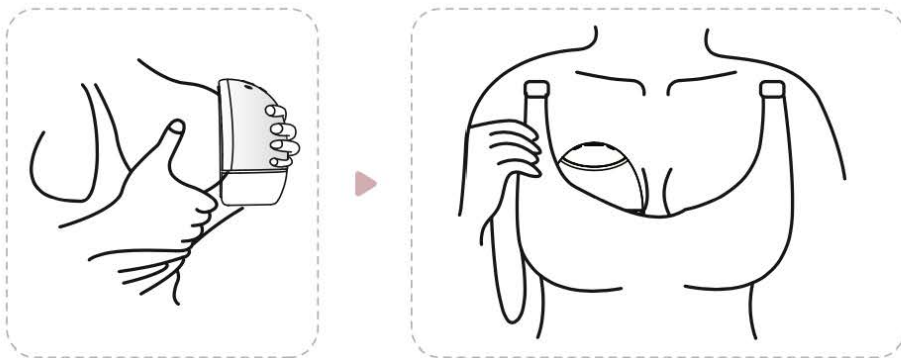

15

Correct nipple alignment in the Breast Shield is key to comfort, expression and performance. Your nipple must be positioned correctly in the Breast Shield tunnel before pumping to avoid discomfort.

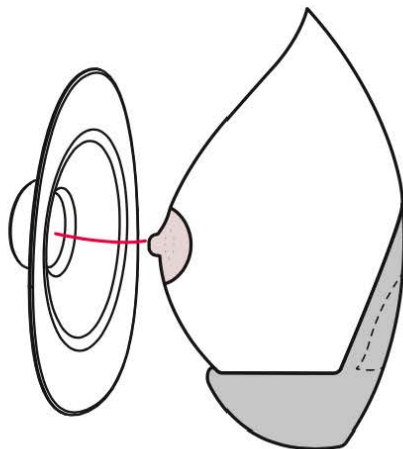

PUMPING CHECKLIST

- ☐ Make sure you are using the correct breast shield size
- ☐ Duckbill valves are clean and not damaged
- ☐ All pump parts are secure
- ☐ Wear a tight supportvie bra
- ☐ Breast shield forms a complete seal around the breast
- ☐ Have extra pump parts handy

PUMPING AT WORK

- ☐ Bottles or milk bags to store milk (pen/marker to label bags with date and time)
- ☐ Insulated cooler with ice packs to keep milk fresh
- ☐ Comfortable pumping bra
- ☐ Baby pictures or videos
- ☐ Water bottle/snacks
- ☐ Have extra pump parts handy
- ☐ Cleaning supplies such as wipes or clean cloth
- ☐ Nursing pads/nipple creams